

# Landscape Design

## 4th stage

Lectures of Asst. Prof. Dr. Hoda Al –Alwan

Prepared by : [Lecturer Dr.Dhirgham Mizher](#)

Presented by : [Asst. Lecturer Amal Fadhil](#)

## Lecture I

# Definition, Concepts, and Overview

The word “**Landscape**” combines “**Land**” with a verb of Germanic origin “*scapjan*” to mean, literally “**Shaped lands**”.

Lands are shaped either by natural forces or by human control.

There are two forms of landscapes:

## Natural Landscape

Under the control of  
natural forces

Unaffected by human  
activity

Beyond cultural influence

## Human Control

Created by human culture

Controlled by people

# Overview

Men lived on earth thousands years ago, they lived in a primitive way. They took caves as their shelter and used stones as their tools that is the stone Age.





After that man learned how to cultivate their food and that's the discovery of agriculture.



The first significant of human on landscape, agriculture



Then villages began to form by those farmers and afterwards states began to appear in its simplest form and here “cultural landscape” appeared to be clear and human impact on landscape took place but yet it was within nature.



This photo shows a village in a valley



Marshes of southern Iraq,  
before their destruction,  
showing how men can  
harmonically live with their  
landscape.

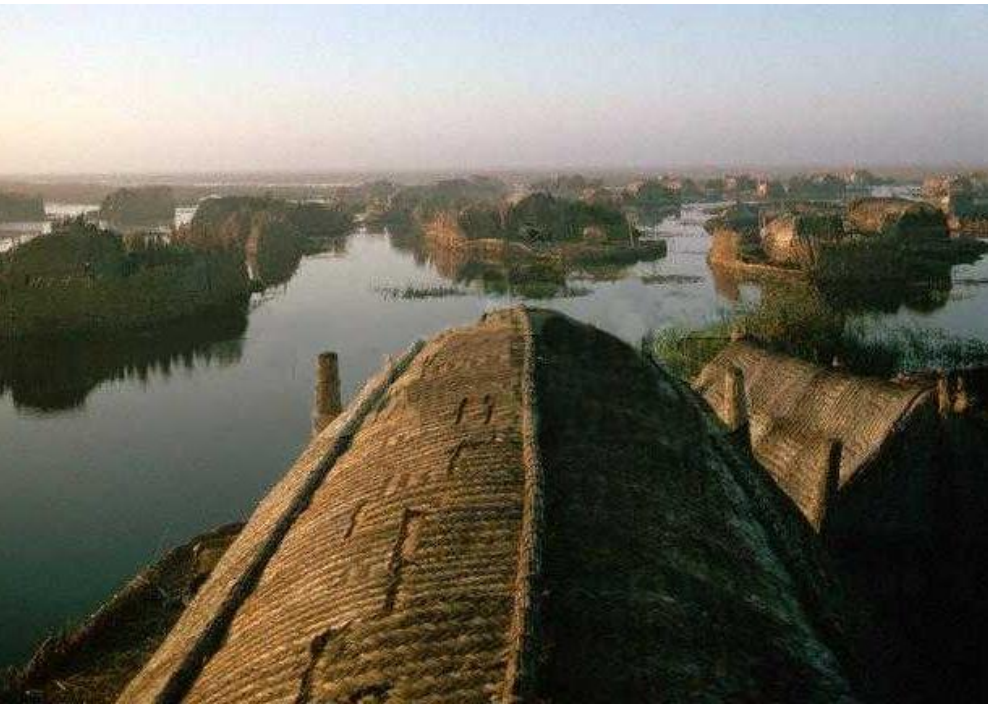



# Human impact on landscape in its simplest way





# Human impact on modern landscape in its most radical way





# Definitions

Landscape:

Land becomes (Landscape) when it is described or seen in terms of its physiographic and environmental characteristics.



Thus, Landscape is a reflection of dynamic, natural and social – cultural systems.



# Landscape design:

Landscape design is the art of arranging land and the objects on it for human use and enjoyment.





# Landscape Architecture:

Landscape architecture is a profession that integrates art and science for the management, planning and design of the entirety of the physical and cultural landscape.

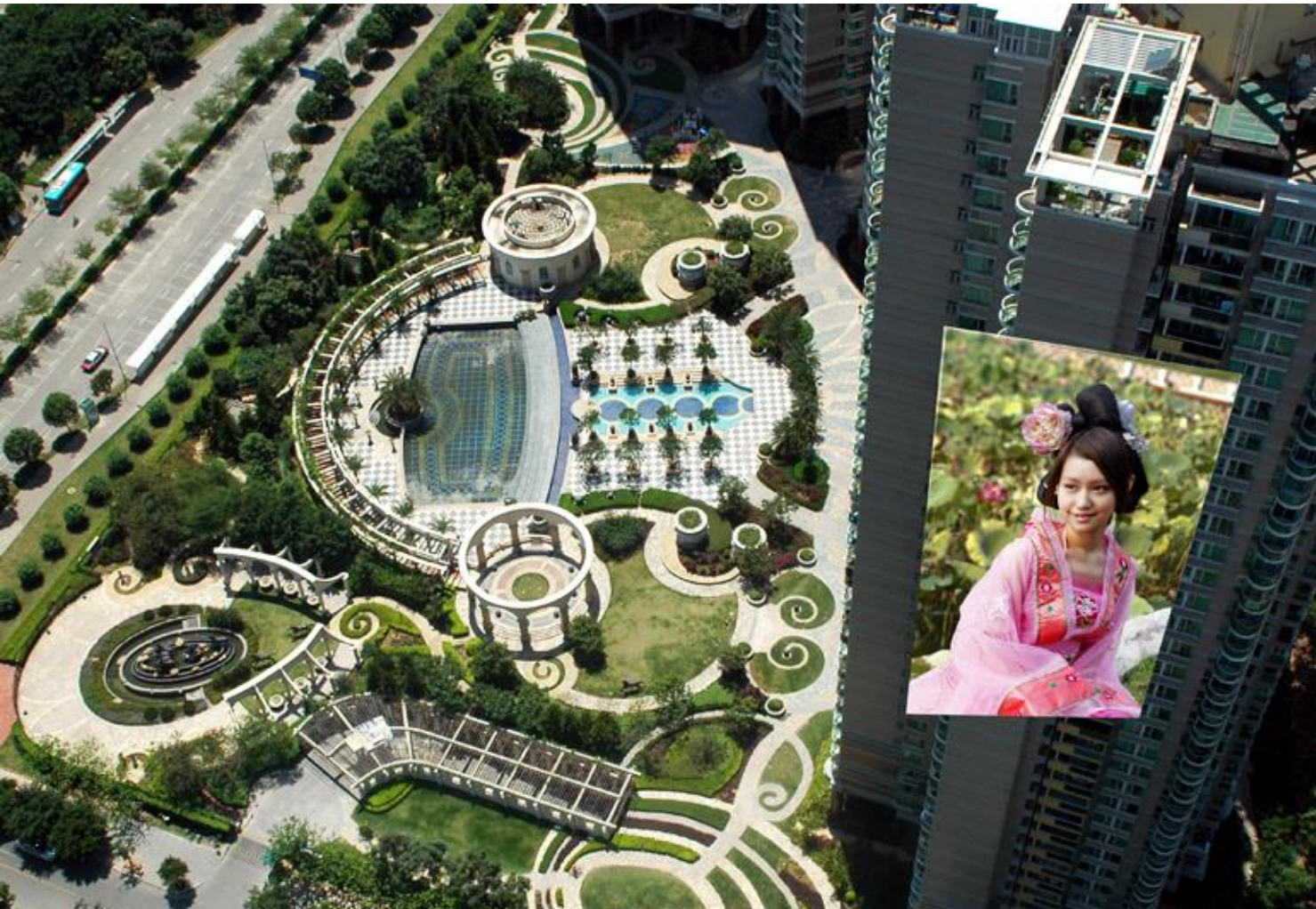



# Landscape is related to:

## 1. Single building

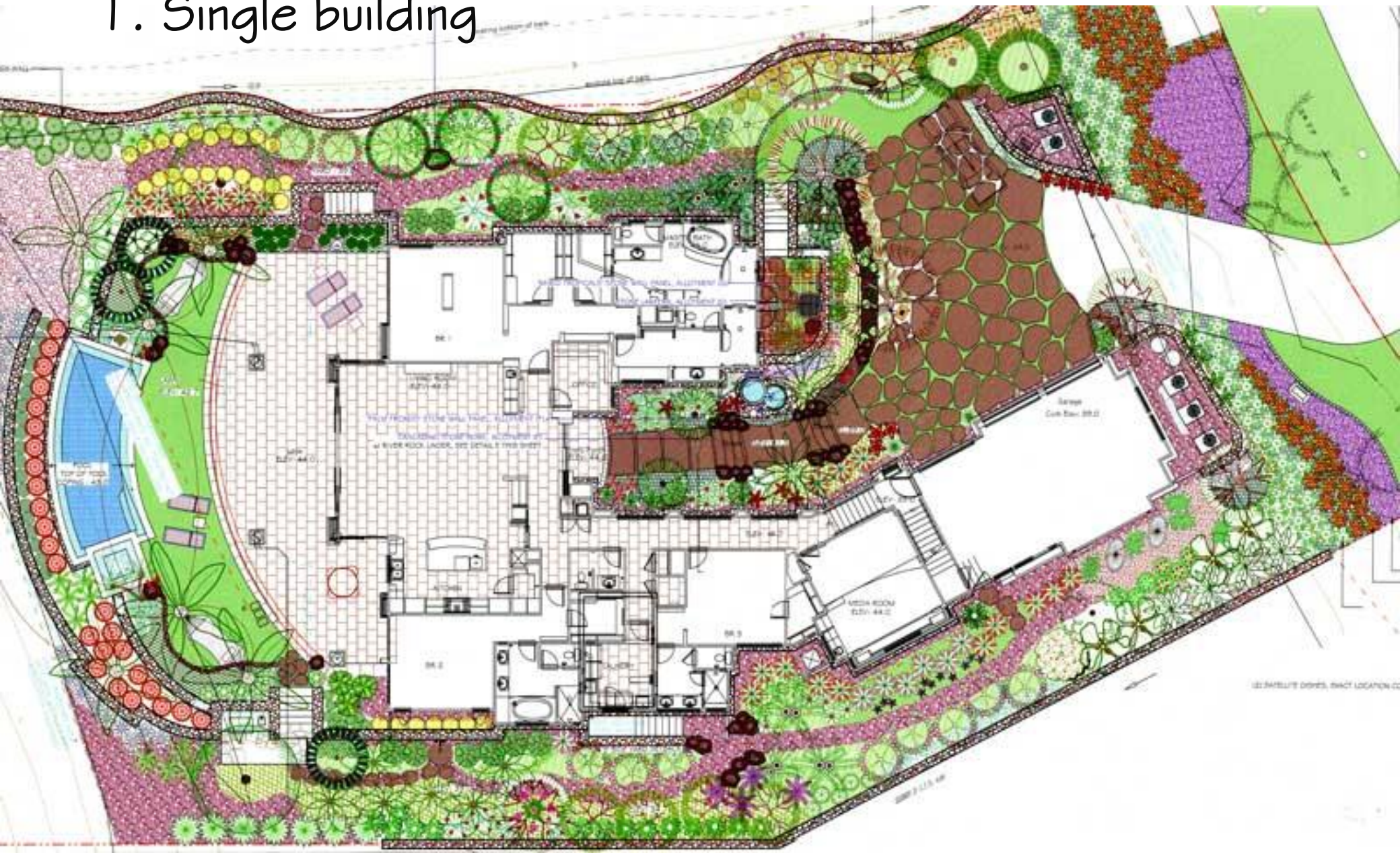



## 2. Group of building:

Housing

Campuses

Civic and cultural centers

Commercial and industrial centers

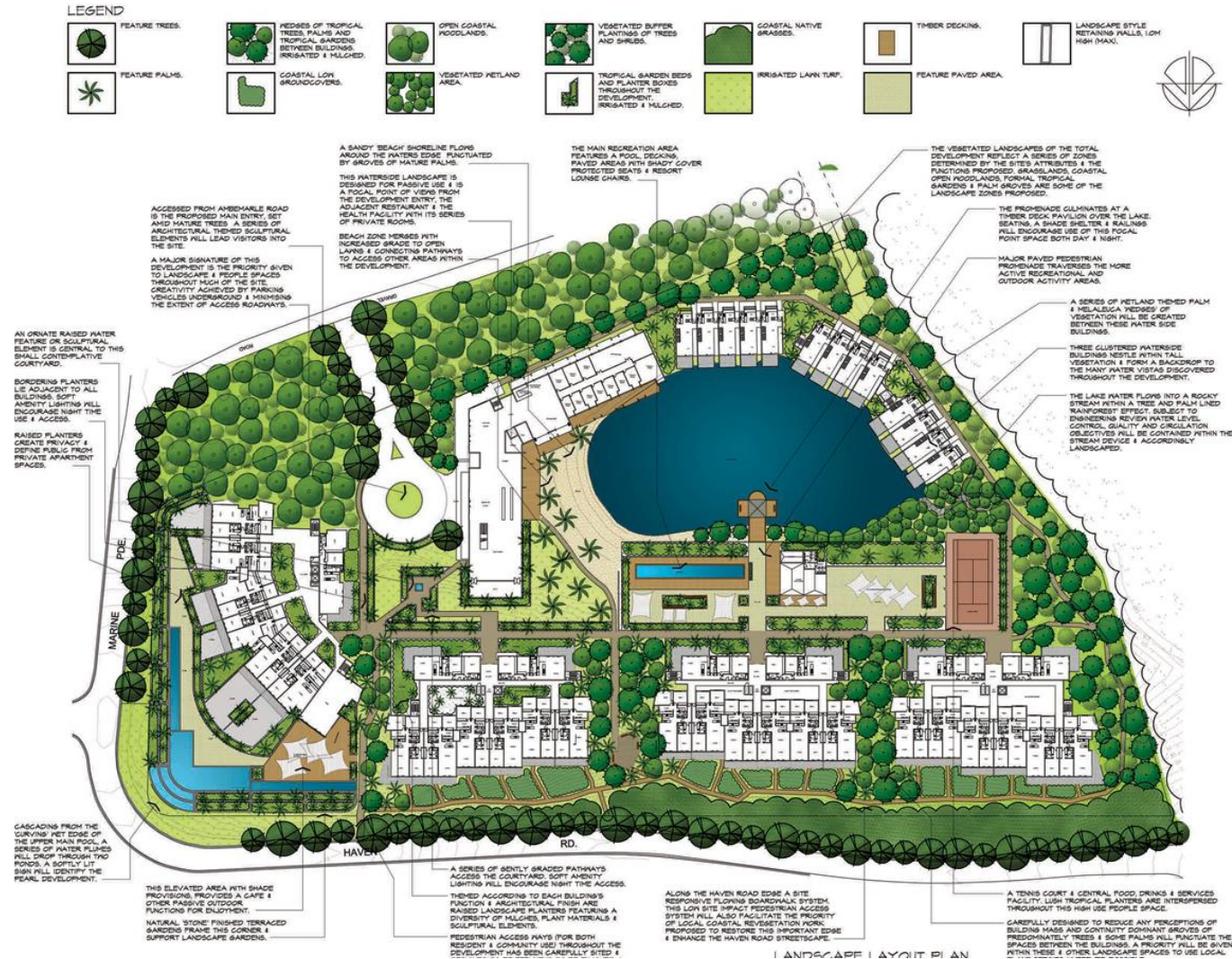



### 3. Transportation and utility corridors: pathways, freeways ... etc.





#### 4. Systems of park – Recreation open space areas:

Urban courtyards, suburban garden, regional, state and national parks, playgrounds, urban playas, covered malls, roof gardens, decks ... etc.





# Landscape Elements

## Physical Elements

Earth

Water

Atmosphere

Building

Trees

Paths

## Cultural Elements

Customs

Laws

Traditions

Permissions

Possibilities

Attitudes



# Physical Elements

```
graph TD; PE[Physical Elements] --> NE[Natural Elements]; PE --> SE[Structural Elements]; NE --> Major[Major]; NE --> Minor[Minor]; Major --> Mountains[Mountains]; Major --> Desert[Desert]; Minor --> Hills[Hills]; Minor --> Woods[Woods]; SE --> Paths[Paths]; SE --> Fences[Fences]; SE --> Fountains[Fountains]; SE --> Furniture[Furniture];
```

## Natural Elements

Major

Mountains

Desert

Minor

Hills

Woods

## Structural Elements

Paths

Fences

Fountains

Furniture



# A. Natural Landscape Elements

## I . Major Landscape Elements:

They are major unalterable natural landscape elements that we must accept and adapt ourselves and our planning to them...



Lakes



Oceans



Mountains



River



# A. Natural Landscape Elements

## 2. Minor Landscape Elements:

They are natural landscape elements that we can modify such as hills, woods, streams and swamps.



Hills



Streams



Woods



Swamps

Actually, there are four general courses of actions in the developing of any natural landscape area or feature:



1. Preservation

الحفاظ على الشكل الطبيعي

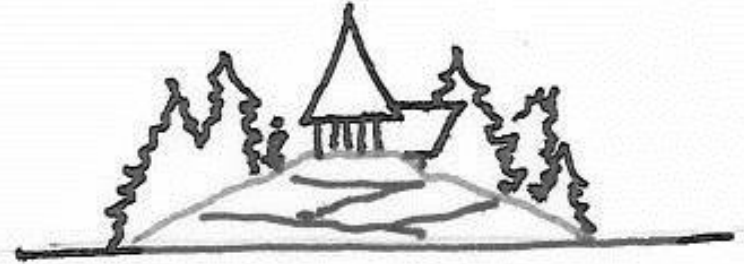

2. Accentuation

- تأكيد وإبراز الشكل الطبيعي



3. Alteration

تحويل وتغيير في الشكل



4. Destruction

إزالة الشكل



# The essence of land planning for any project:

1. Determine the suitable site.
2. Let the site suggest plan forms.
3. Extract the full site potential.

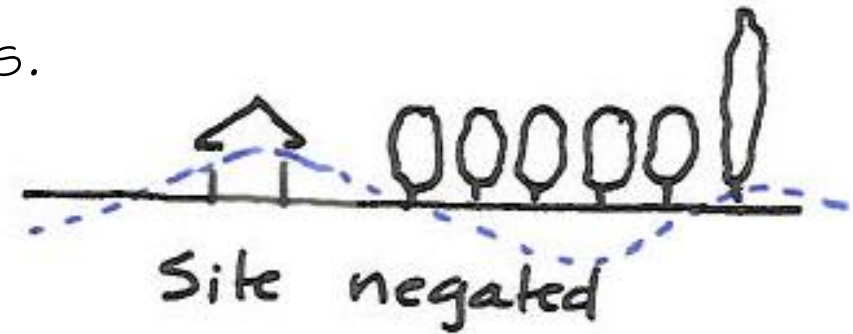

## B. Structural Landscape Elements

Structural or man – made elements include roads, paths, walkways, ground levels, fences, fountains, pools, artificial lakes or ponds, furniture, lighting ... etc.

The most constant quality of the man – made landscape is the quality of change (improvement or destruction).





# Development of Landscape Architectural Design

Pre 1960 s:

Landscape Architecture Design had two foundation:  
art / aesthetics and the technologies by which the  
society built.

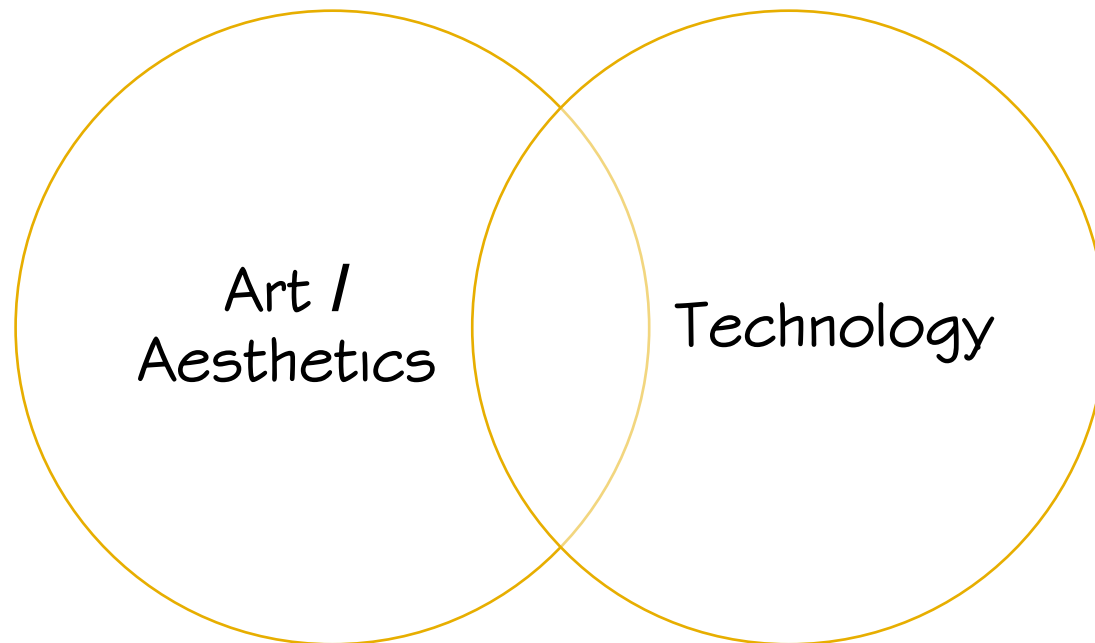

Landscape Architecture

## Post 1960 s:

The book titled (Design with nature, 1969) and the application of system thinking to landscape design developed a third foundation (natural system).

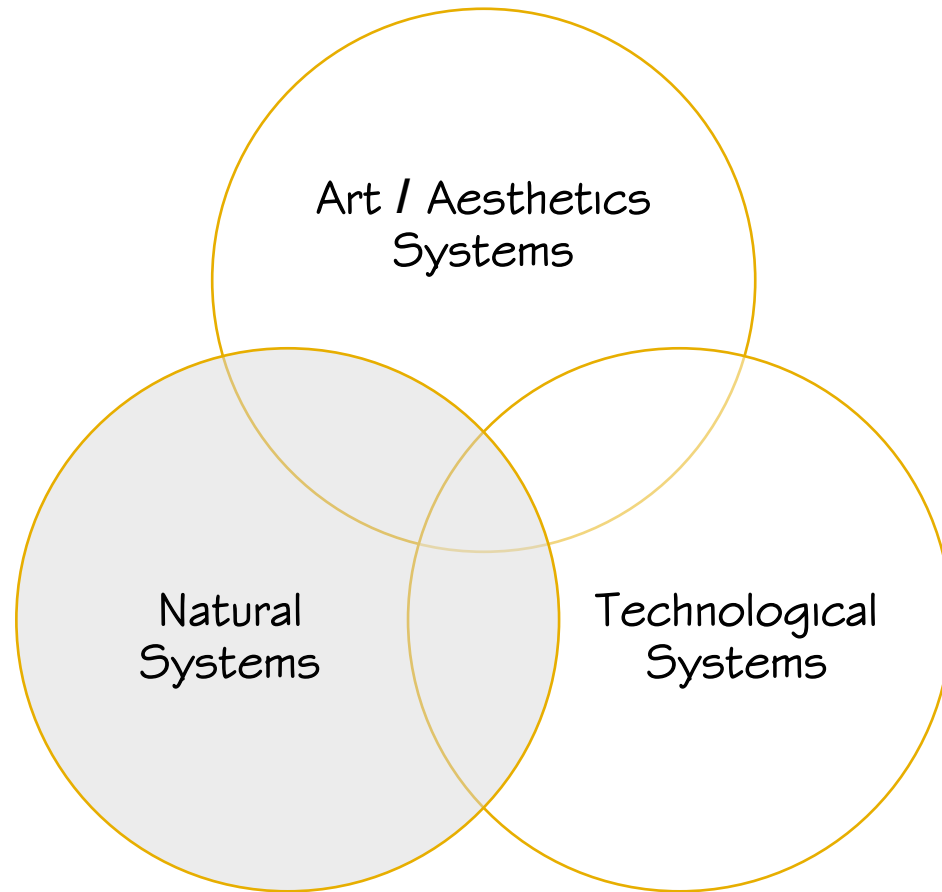

Landscape Architecture



# Current Landscape Architectural Design

A fourth foundation was developed (human system) generated from human sciences (sociology, psychology, environmental psychology).

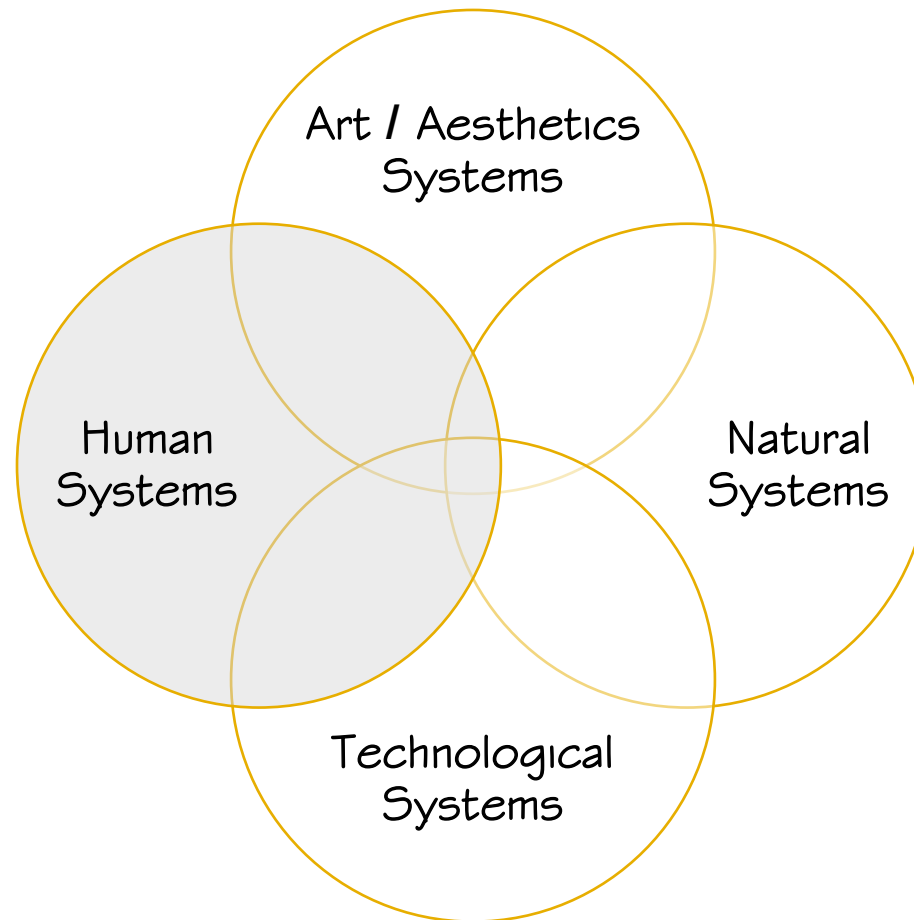

Landscape Architecture

# Design Process and Landscape Architecture:

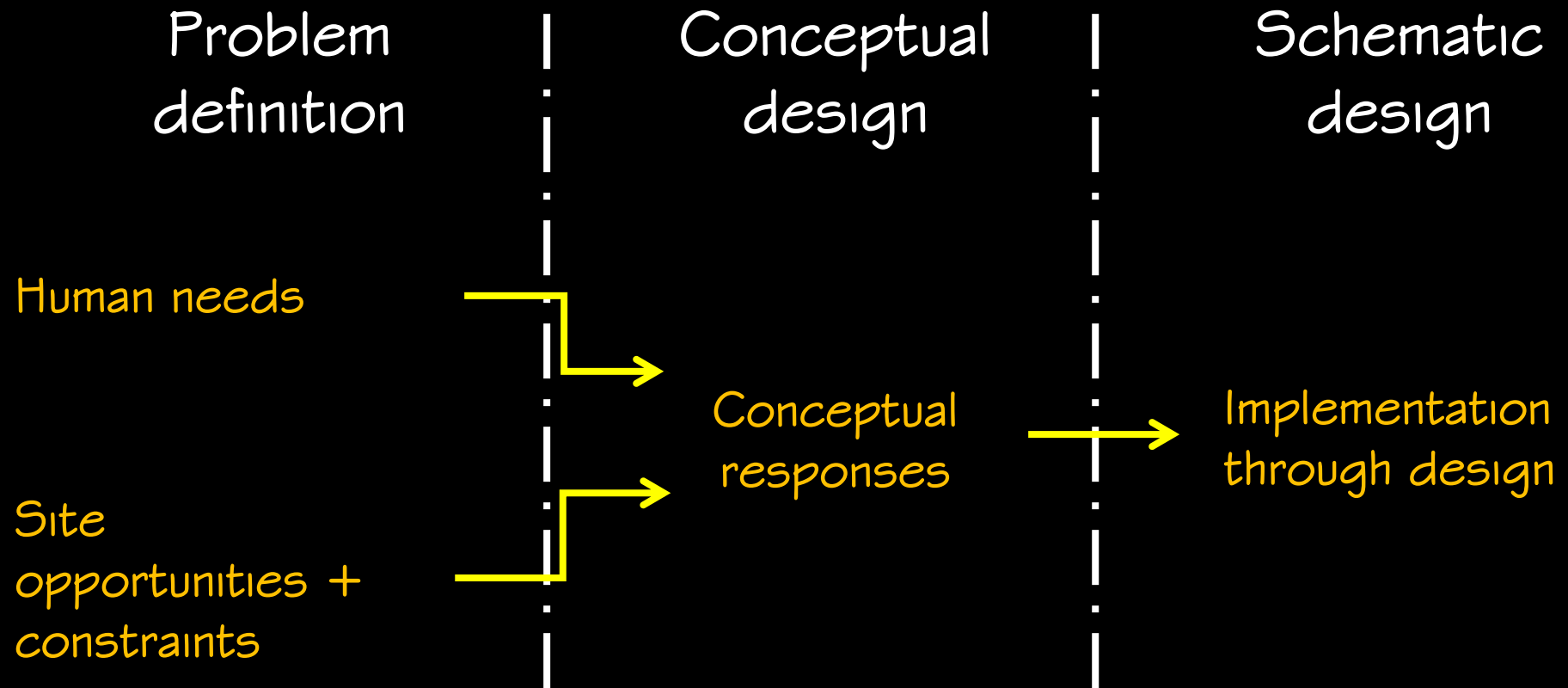

Typical Design Process



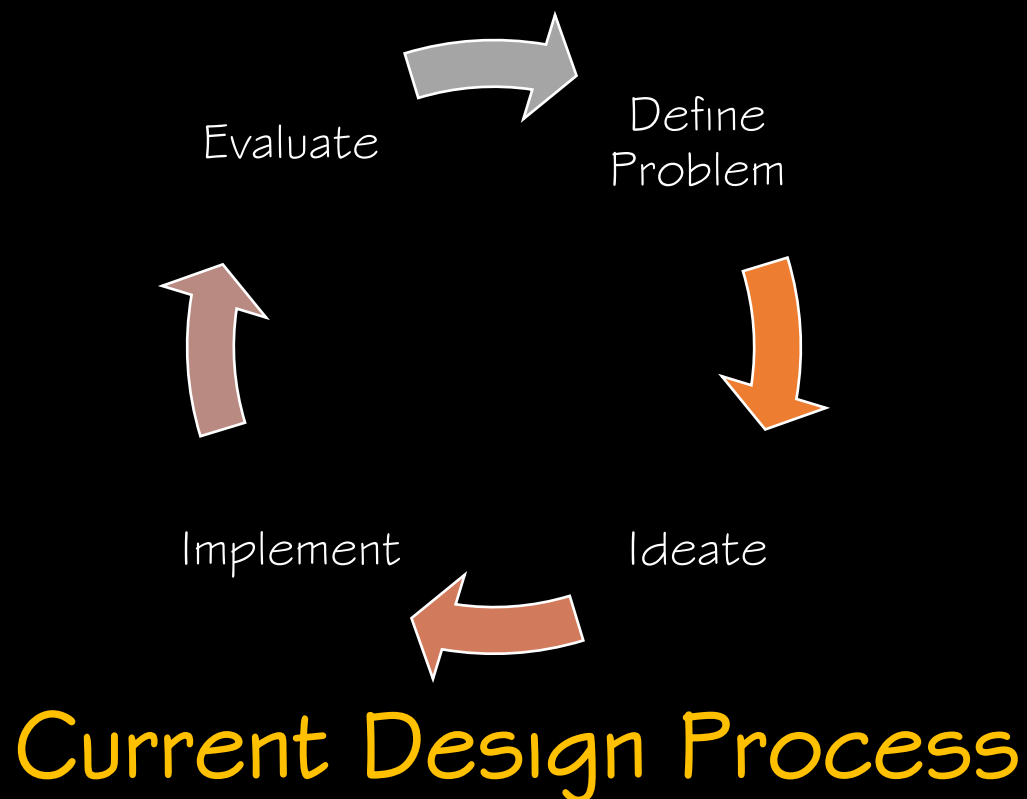
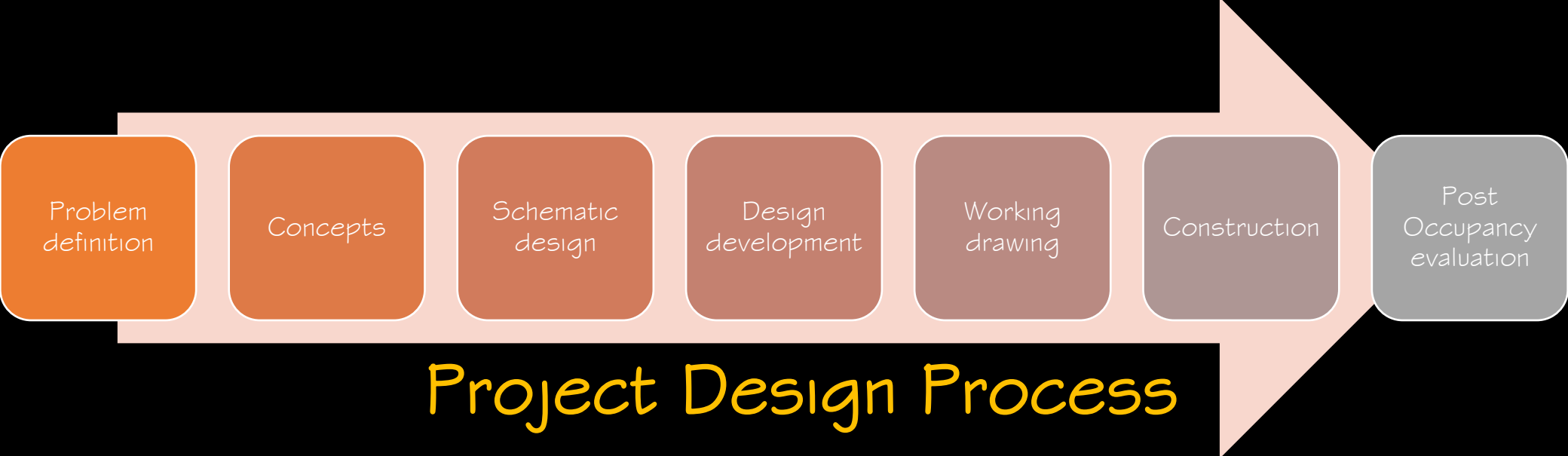

Thanks for Listening